

User Manual



Tuning solutions



Product features

- Wireless/wired carplay, Android auto available
- Support wireless/wired phone mirroring
- Compatible with OEM microphone
- USB multimedia available
- External rear camera, front camera can be linked
- Support EQ adjustment, lossless sound quality
- Working with steering wheel button and idrive system

Accessories

Power cable



CAN-Q5U



CAN-A6



CAN-A8



CAN-C6



CAN-Q3S-V4



CAN-A7C



CAN-B9



CAN-Q5L



CAN-Q3H



CAN-A6 RMC

Common cables



LVDS cable



Wifi antenna



USB cable

Cable special for RMC and Q5L



Mic adapter cable



Microphone

DIP code setting

Model	Year	System version	DIP code	CAN cable	BOX label
Q5	13-18	3GMMI	000000	Q5U	Q5H
S4/S4/A4/A5	12-16	3GMMI	000111		
S4/S4/A4/A5/Q5	10-12	3GMMI	000000	A6	
S6/S7/A6/A7	12-16	3GMMI	000001	A8	
A6/A7 RMC	12-16	3GMMI	High CAN connection 000000 / 000001	A6 RMC	
			LOW CAN connection 001110		

S6/A6(C6)	10-11	3GMMI	001101	C6	Q5H
Q7	10-15	3GMMI	000010		
S6/S7/A6/A7	16-18	MIB2	001111	A7C	
S3/A3	14-16(5.8/6.3)	MIB	110011	B9	
S3/A3	14-16(7 inch)	MIB	111001		
S3/A3	17-18(6.3 inch)	MIB	110110		
S3/A3	17-18(7 inch)	MIB	111000		
Q2	19(7 inch)	MIB2			
B9/A4/S5/A5	14-19(7 inch)	MIB2	110100		
Q7	16-18	MIB2	111011		
Q5	18-19(7 inch)	MIB2			
Q3 with navi	14-18(7 inch)	2GMMI	001100	Q3H	
Q3 no navi	14-18(6.3 inch)	2GMMI	001100	Q3S-V4	
A1	14-18(5.8/6.3 inch)				
Q5/A4/A5 (NO MMI)	10-18(6.3 inch)	2GMMI	000101	Q5L	Q7
A4/A5	14-19(8.3 inch)	MIB2	110100		
Q7	16-19(8.3 inch)				
A3	17-18(8.3 inch)				
Q2	19(8.3 inch)		111000		
Q5	18-19(8.3 inch)			111011	

Connection Diagram

Connection for A3/A4/A5/Q5

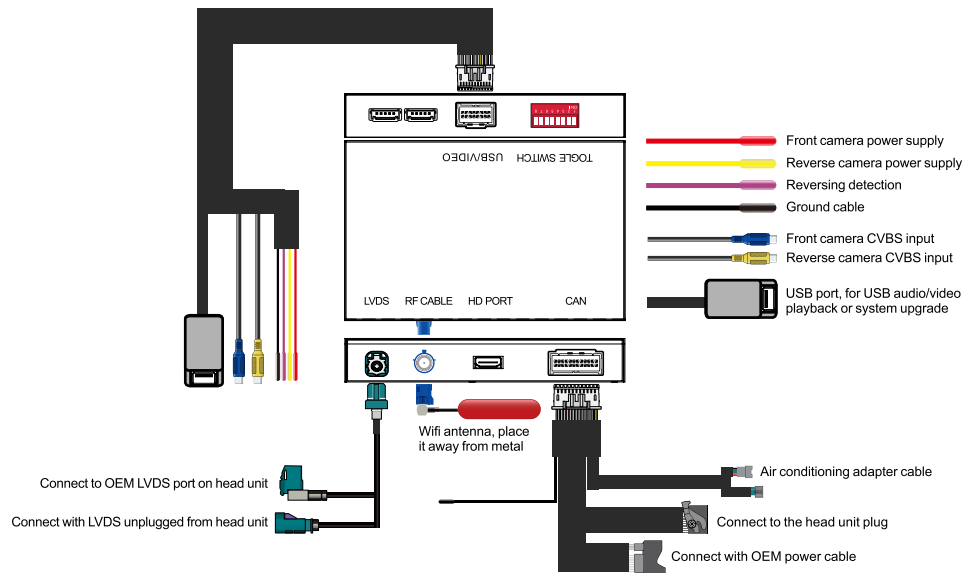

Connection for A4/A5/Q5 NO MMI

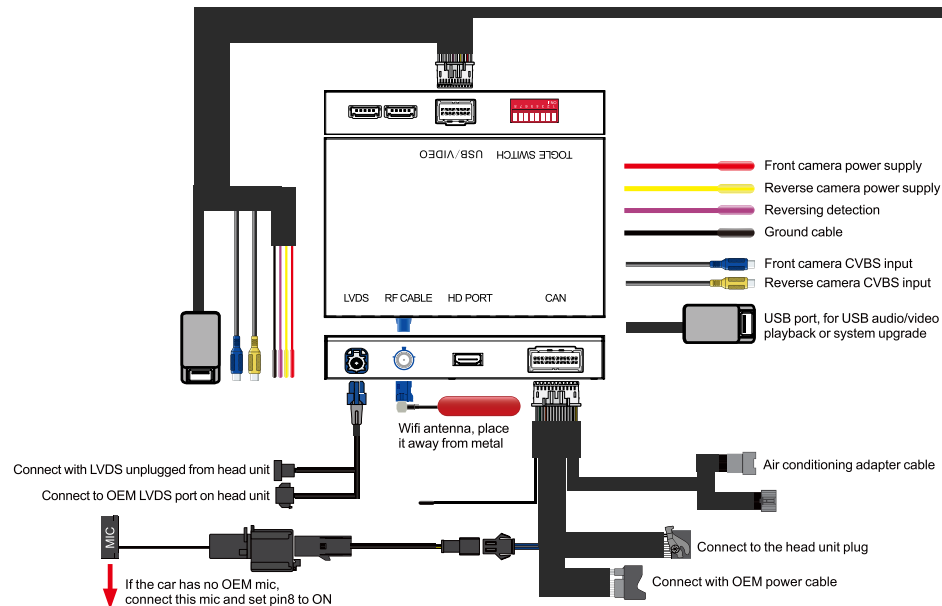

Note:

1. The area that is marked by blue color can't be bent or broken, which probably has effect on the original car system, can't boot. (Fig1)
2. Pay attention to the direction of FPC while plugged in slots as the show in pics. (Fig 2)

FPC connection

1. Transfer panel button cable, fix the transfer board with original car screws after connection
2. Power needs to be disconnected during installation.

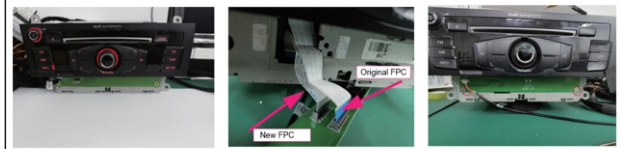

Complete the transfer of air conditioning panel

Unplug power cable of the head unit

Plug into the host port



Connection for Q3/A1 no navi

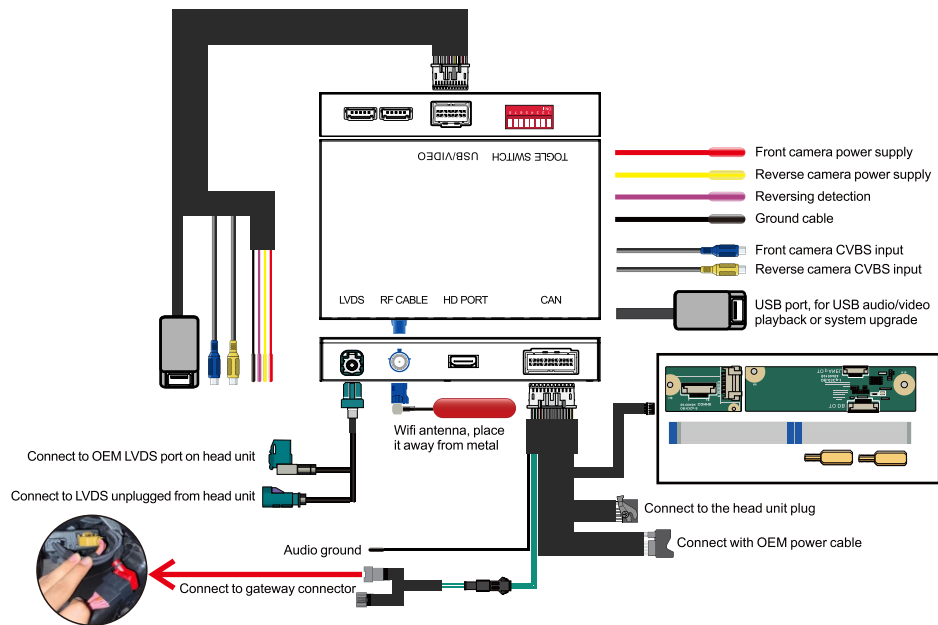

Q3 FPC Adapter Board Installation

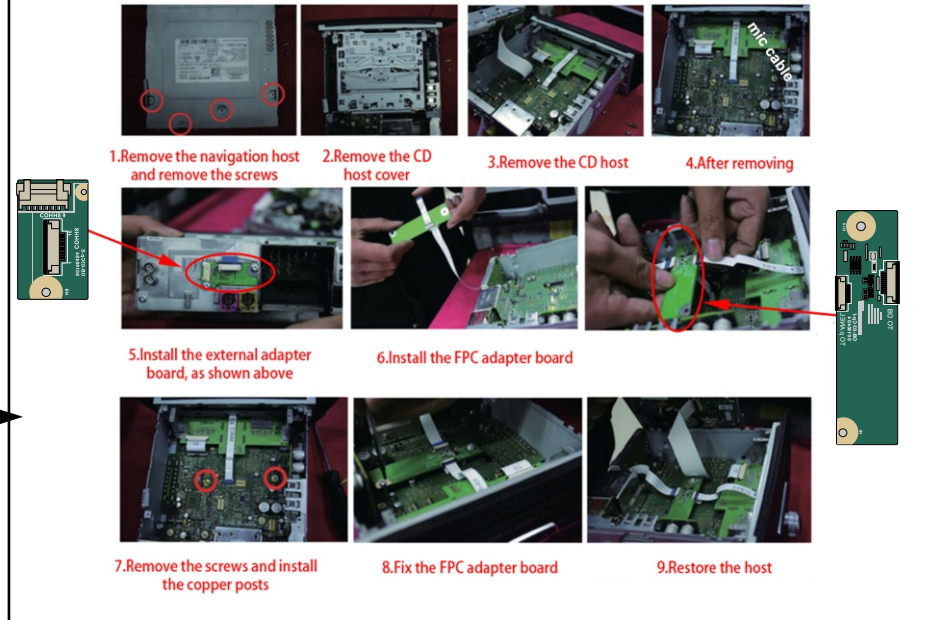

Connection for Q3 with navi

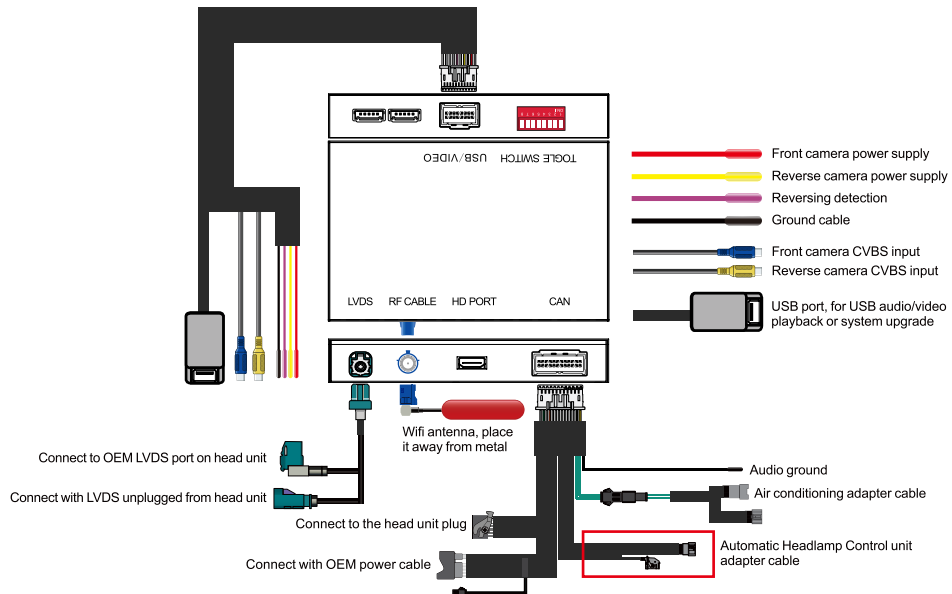

Connection for A8

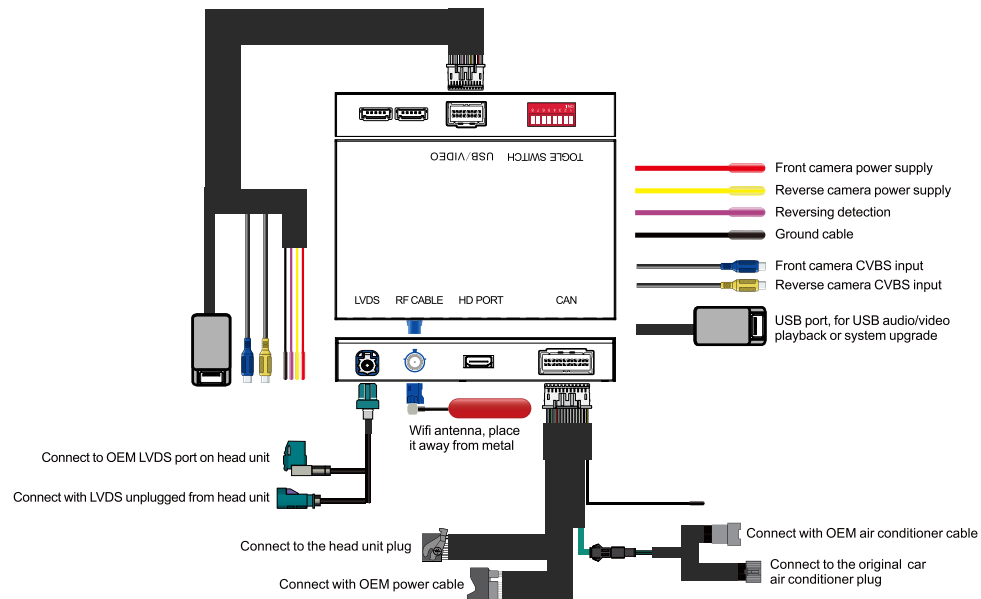

Connection for A6/A7

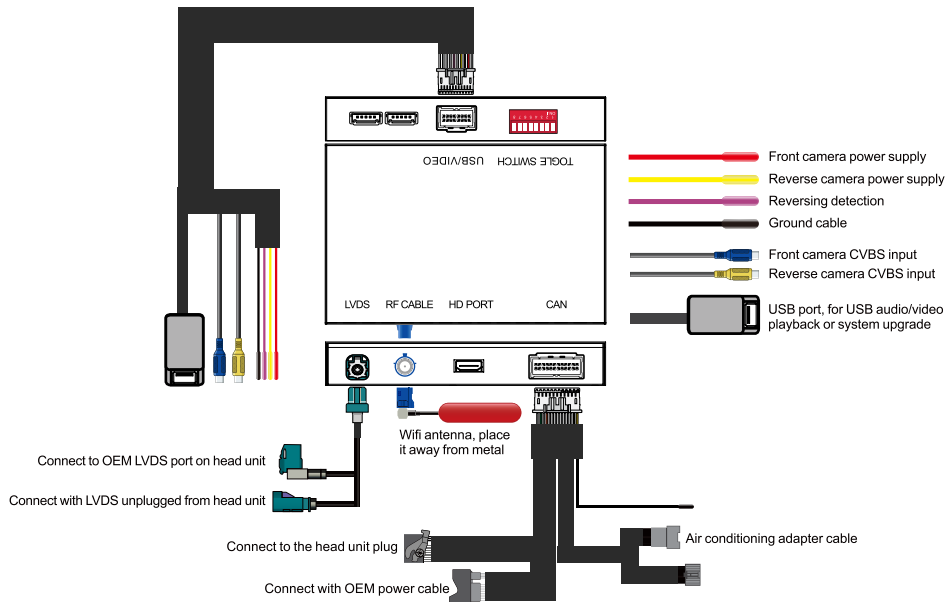

Connection for A6(C6)/Q7

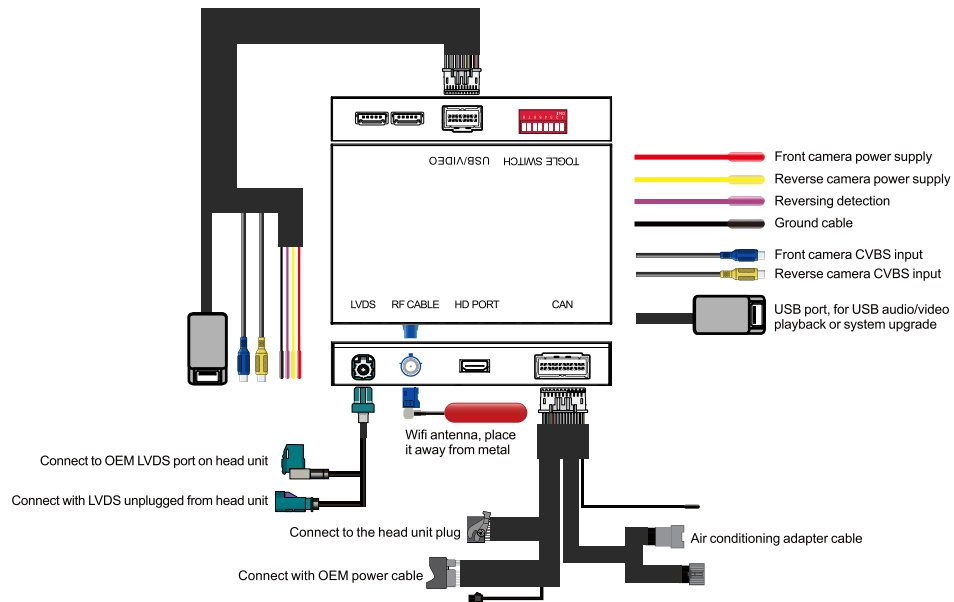

Connection for A3/S3/A4/A5/Q7 MIBII

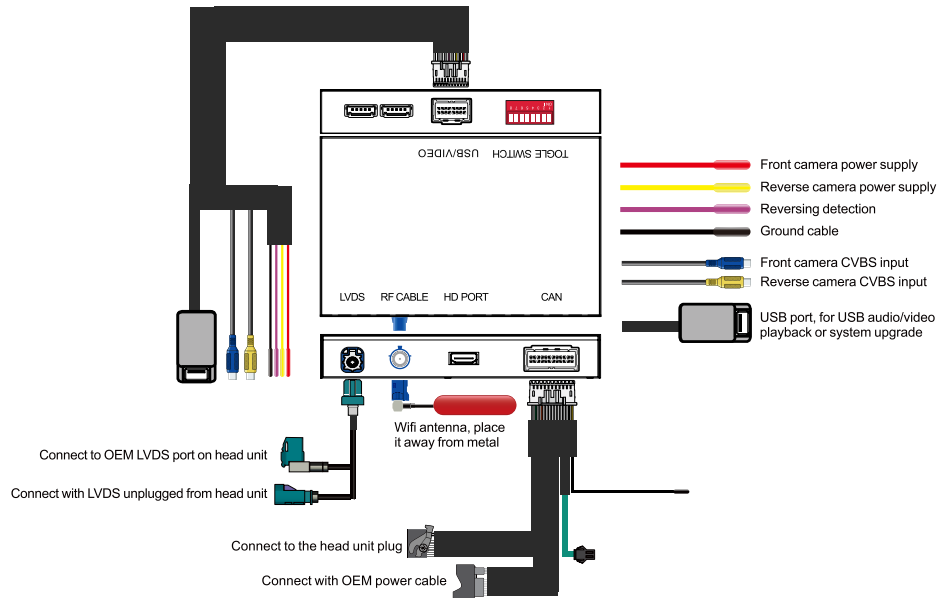

Connection for A6/A7 RMC

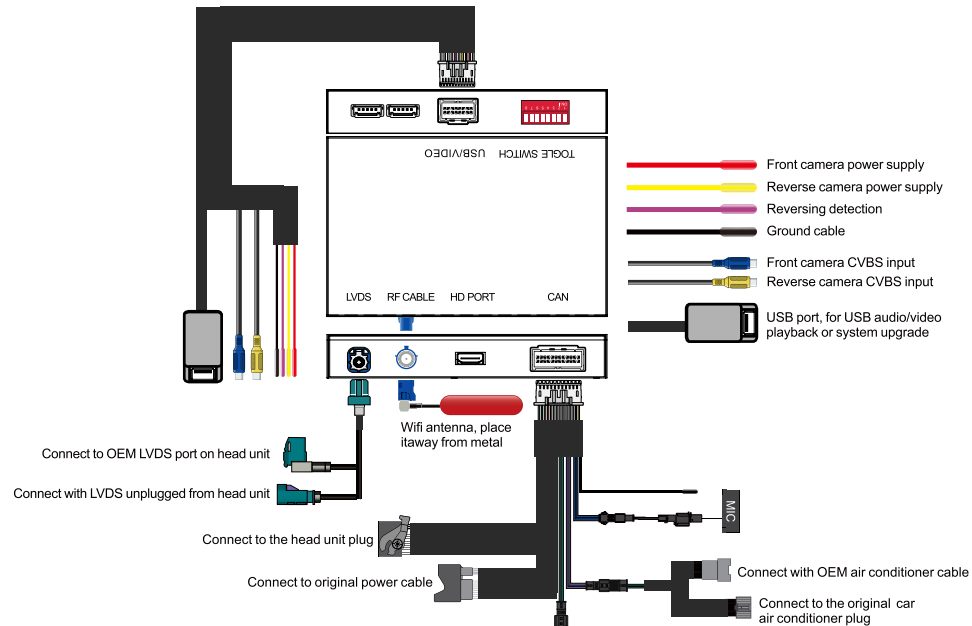

Wireless Car Play connection

1. Turn on Wifi on the phone
2. Turn on Bluetooth on the phone
3. Search Car Play's Bluetooth 'Car Play xxx'
4. After Bluetooth pairing is successful, click 'Allow', 'Use Car Play' in turn, then Car Play connected successfully

Wired Android auto connection

1. Enter 'WireAuto' APP when switching to Car Play system
2. Pop up the prompt 'Please connect your Android device'
3. Plug the Android phone to USB port by USB charging cable, then Android auto can be connected successfully

Wireless Android auto connection

1. Turn on Wifi on the phone
2. Turn on Bluetooth on the phone
3. Enter 'Car Play' APP when switching to Car Play system
4. Search the Bluetooth of the phone
5. Choose any one of the options on the car end to pair
6. The pairing request pops up on the phone, select 'Pair'

Wireless Airplay connection

1. Select 'Airplay' APP on the car, then the pairing information with the phone will be displayed
2. Search wifi signal of Airplay and enter password 8888888 to pair

3. Swipe the screen up and down on the mobile phone and find the screen mirroring in the task bar
4. Click 'airplay' to search the the signal of Car Play box

Note: if you have connected Car Play before, please disconnect Car Play wifi first

Wired Autolink connection

1. Download and install 'Autolink' APP on the Android phone
2. Plug the Android phone to USB port of the Car Play box by USB charging cable
3. Open Autolink and allow all the permissions, then can connect Autolink successfully

Reverse camera connection

Automatic transmission

1. Connect the reverse camera to CVBS labeled 'Reverse camera'
2. Connect the cable labeled '12V Reverse camera' to camera power
3. Setting→Reverse→Reverse camera→Aftermarket



Manual transmission

1. Connect the reverse camera to CVBS labeled 'Reverse camera'
2. Connect the cable labeled 'Reverse 12V IN' to camera power
3. Setting→Reverse→Reverse camera→Aftermarket

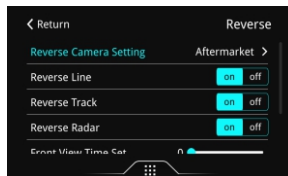

Use original car's Bluetooth channel

1. Turn on setting 'Use original car's BT channel'
2. Search and connect original car's BT on phone first
3. Search and connect carplay's BT 'EW-CPXXX'
4. After connecting, the sound of carplay will output by original car's BT instead of AUX



Notes: Screen mirroring and USB audio-video functions will not have audio output when using this function.

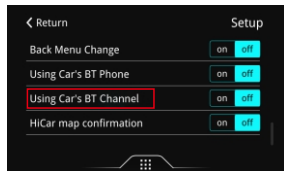

Description of the function of the original buttons



A6 3G MMI controller



A4 3G MMI controller



A8 3G MMI controller

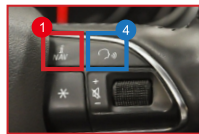

Q3/A1 controller



A3 MIB II controller



Q5L controller



Steering wheel buttons

- | | |
|--|---|
| <p>1 System switching: long press 3s to switch in Carplay and OEM system</p> <p>2 Move the pointer: turn the dial
Confirm: short press
Activate siri/google assistant: long press 5s in carplay system</p> | <p>3 Return to the previous menu: short press
Restart box: long press 5s</p> <p>4 Activate siri/google assistant: long press 5s</p> |
|--|---|